



Stretham Road, Wilburton, CB6 3RX

CHEFFINS

Stretham Road

Wilburton,
CB6 3RX

Detached 2 bedroom house. Accommodation comprises entrance hall, kitchen, dining room, living room, 2 bedrooms, study/dressing room accessed through bathroom, bathroom, garden and off road parking. Available: 22/04/2026. Deposit: £1,153. Holding fee: £230. Council tax band: C. EPC: E

LOCATION

Wilburton has a range of village amenities and is conveniently situated 2 miles from the larger village of Haddenham and 6 miles from the Cathedral City of Ely. Cambridge is located 11 miles to the South with excellent access to London. Mainline rail services are situated at Ely to Cambridge and London.

2 1 2

£1,000 PCM





ENTRANCE HALL

with sideboard.



KITCHEN

with vinyl flooring, double electric cooker with ceramic hob, fridge/freezer and washing machine.

STORE

with window and shelving.



DINING ROOM

LIVING ROOM

with built in cupboards.



BEDROOM

BEDROOM

STUDY/DRESSING ROOM

accessed via the bathroom.



BATHROOM

with vinyl flooring, WC, hand basin and bath.



OUTSIDE

Rear garden, and 2 off road parking spaces.

LETTING AGENTS NOTES

For more information on this property please refer to the Material Information brochure on our Website.

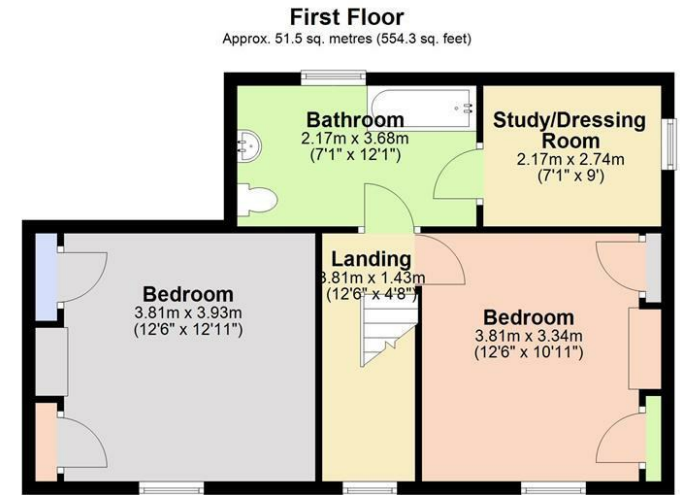

Total area: approx. 101.8 sq. metres (1095.5 sq. feet)

Energy Efficiency Rating

	Current	Potential
<i>Very energy efficient - lower running costs</i>		
(92 plus) A		
(81-91) B		82
(69-80) C		
(55-68) D		
(39-54) E	43	
(21-38) F		
(1-20) G		
<i>Not energy efficient - higher running costs</i>		
England & Wales	EU Directive 2002/91/EC	

Agents note:
For more information on this property please refer to the Material Information Brochure on our website.

25 Market Place, Ely, Cambridgeshire, CB7 4NP | 01353 663144 | cheffins.co.uk

IMPORTANT: we would like to inform prospective purchasers that these sales particulars have been prepared as a general guide only. A detailed survey has not been carried out, nor the services, appliances and fittings tested. Room sizes should not be relied upon for furnishing purposes and are approximate. If floor plans are included, they are for guidance only and illustration purposes only and may not be to scale. If there are any important matters likely to affect your decision to buy, please contact us before viewing the property.

